

CURVE TABLE

CURVE	RADIUS	CHORD LENGTH	CHORD BEARING	CURVE	RADIUS	CHORD LENGTH	CHORD BEARING
C1	25.00'	35.91'	N 10°29'40" E	C16	75.00'	37.84'	N 44°08'50" E
C2	400.00'	60.23'	N 60°43'34" E	C17	75.00'	43.12'	N 12°49'46" E
C3	400.00'	84.42'	N 71°06'05" E	C18	75.00'	39.18'	S 19°01'01" E
C4	400.00'	87.17'	N 83°24'51" E	C19	25.00'	38.33'	N 15°53'19" E
C5	400.00'	9.00'	S 89°41'10" E	C20	480.00'	79.72'	N 61°10'19" E
C6	400.00'	37.29'	N 88°17'13" E	C21	25.00'	34.79'	S 79°30'20" E
C7	400.00'	69.21'	N 80°39'08" E	C22	25.00'	27.99'	S 68°11'57" E
C8	400.00'	94.09'	N 68°56'05" E	C23	480.00'	79.84'	N 82°31'50" E
C9	350.00'	72.71'	N 69°30'49" E	C24	480.00'	30.63'	N 89°07'47" E
C10	50.00'	71.31'	S 59°01'58" E	C25	25.00'	39.53'	N 38°42'31" E
C11	100.00'	49.64'	S 27°54'46" E	C26	50.00'	36.61'	S 35°00'48" E
C12	100.00'	24.72'	S 49°23'07" E	C27	25.00'	26.77'	S 88°51'46" E
C13	75.00'	20.54'	S 64°21'18" E	C28	25.00'	36.24'	N 12°18'04" E
C14	75.00'	43.05'	S 88°54'03" E				
C15	75.00'	20.44'	N 66°35'29" E				

**THE ESTATES OF ELK RUN
SECTION ONE**

CERTIFICATE OF CLARK COUNTY PLAN COMMISSION

THIS IS TO CERTIFY THAT THE WITHIN PLAT WAS EXAMINED AND APPROVED BY THE CLARK COUNTY PLAN COMMISSION ON THE _____ DAY OF _____ 2005, IN ACCORDANCE WITH THE PROVISIONS OF AN ORDINANCE ADOPTED DECEMBER 28, 1950, BY THE BOARD OF COUNTY COMMISSIONERS OF CLARK COUNTY, INDIANA, CREATING SAID PLAN COMMISSION AND AN ORDINANCE OF SAID BOARD OF COUNTY COMMISSIONERS ADOPTED FEBRUARY 1, 2000, ENACTING REQUIREMENTS AND PROCEDURES RELATIVE TO THE SUB-DIVIDING AND PLATTING OF UNINCORPORATED AREAS WITHIN THE LIMITS OF CLARK COUNTY, INDIANA.

CLARK COUNTY PLAN COMMISSION

BY _____
PRESIDENT

ATTEST: _____
SECRETARY

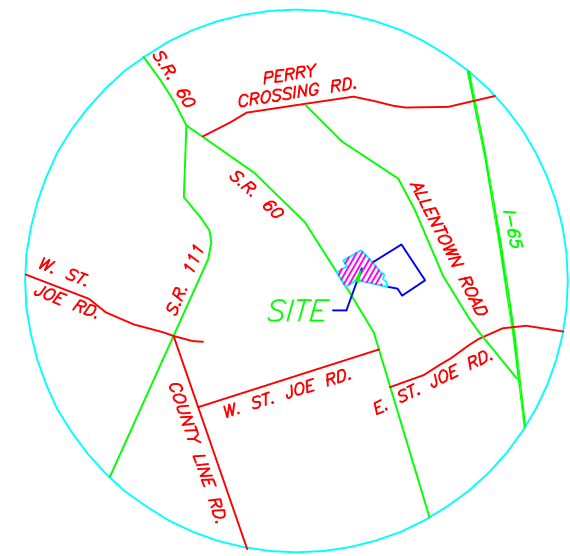
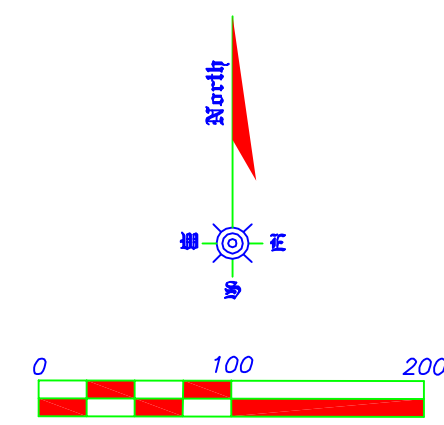

**LOCATION MAP
NOT TO SCALE**



DESCRIPTION

Being a part of Survey No. 146 of the Illinois Grant to Clark County, Indiana and being further described as follows:

Beginning at a stone marking the eastern corner of said Survey no. 146; Thence N.35°26'10"W. along the northeastern line of said Survey no. 146, 312.6 feet to a steel pin; Thence N.35°26'13"W. along the Northeastern line of Survey no. 146, 37 feet to an iron pipe; Thence S.54°19'W. 719.57 feet to an iron pipe; Thence N.35°25'30"W., 218.06 feet; Thence N.33°54'34"W., 123.5 feet; Thence N.40°10'16"W., 213.95 feet; Thence N.88°43'36"W., 189.08 feet to THE TRUE PLACE OF BEGINNING;

Thence continuing N.88°43'36"W., 802.58 feet;
Thence S.55°44'10"W., 419.09 feet to a steel pin on the northeast right-of-way line of State Highway 60;
Thence N.35°30'11"W., along said right-of-way line, 368.34 feet to a concrete right-of-way marker;
Thence N.34°28'W., along said right-of-way line, 75.8 feet to an iron pipe;
Thence N.55°39'50"E., 319.2 feet to an iron pipe;
Thence N.33°40'30"W., 173.48 feet to an iron pipe;
Thence N.57°05'18"E., 43.21 feet;
Thence N.58°40'37"E., 485.24 feet to a stone;
Thence S.46°05'10"E., 444.4 feet to a stone;
Thence S.8°25'48"W., 30.19 feet;
Thence S.37°28'59"W., 90.7 feet;
Thence S.12°18'22"E., 52.75 feet;
Thence S.37°23'33"E., 169.03 feet;
Thence N.70°48'26"E., 82 feet;
Thence S.37°56'17"E., 66.07 feet;
Thence S.78°34'31"E., 52.13 feet;
Thence S.17°22'53"W., 66.72 feet;
Thence S.89°15'02"W., 67.62 feet;
Thence S.20°45'17"E., 20.02 feet to THE TRUE PLACE OF BEGINNING.

Containing 12.525 acres, and being subject to all easements of record.

CERTIFICATE OF DEVELOPER AND DEDICATION

THE UNDERSIGNED JEFFREY CORBETT, MEMBER OF B C LAND DEVELOPMENT CO. L.L.C., _____, A RESIDENT OF CLARK COUNTY, INDIANA, BY THIS CERTIFICATE HEREBY CAUSES THE REAL ESTATE HEREIN DESCRIBED TO BE SUBDIVIDED AND PLATTED INTO LOTS AND STREETS AS SHOWN ON THIS PLAT. THE STREETS AND EASEMENTS AS SHOWN ON SAID PLAT ARE HEREBY DEDICATED TO THE PUBLIC USE FOR THE PURPOSES INDICATED THEREIN; AND THE RESTRICTIONS AS RECORDED IN MISCELLANEOUS DRAWER _____ INSTRUMENT _____ ARE IMPOSED ON EACH AND EVERY LOT WITHIN SAID PLAT AND DECLARED TO BE COVENANTS RUNNING WITH THE LAND. SAID RESTRICTIONS ARE FOR THE BENEFIT OF ALL PERSONS AND CORPORATIONS WHO MAY HEREAFTER HAVE ANY VESTED INTEREST, LEGAL OR EQUITABLE, IN ANY LOT WITHIN SAID PLAT.

IN WITNESS THEREOF, JEFFREY CORBETT, MEMBER OF B C LAND DEVELOPMENT CO. L.L.C., _____, HAS CAUSED THIS PLAT TO BE MADE AND THIS CERTIFICATE TO BE EXECUTED FOR AND ON HIS BEHALF AND HIS SEAL AFFIXED HERETO THIS _____ DAY OF _____ 2005.

BY: _____
JEFFREY CORBETT

ACKNOWLEDGMENT

STATE OF INDIANA SS
COUNTY OF CLARK
BEFORE ME, THE UNDERSIGNED NOTARY PUBLIC IN AND FOR THE COUNTY AND STATE, PERSONALLY APPEARED JEFFREY CORBETT AND ACKNOWLEDGES THE EXECUTION OF THE FOREGOING INSTRUMENT AS HIS VOLUNTARY ACT AND DEED, FOR THE PURPOSES THEREIN EXPRESSED. WITNESS MY HAND AND NOTARIAL SEAL THIS _____ DAY OF _____ 2005.

COUNTY OF RESIDENCE _____
MY COMMISSION EXPIRES: _____

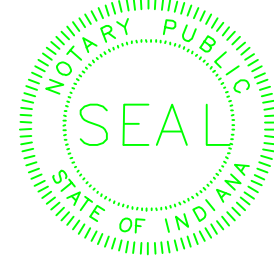

- NOTES:**
- (1) This property is not located in flood zone A or B, according to flood map #180426 0125 C, dated February 18, 1983.
 - (2) Title examination may reveal other easements and/or Rights of ways not shown hereon.
 - (3) All rear lot corners are monumented with 5/8"x 24" steel pins with plastic caps. All front lot corners are witnessed by a cut in the concrete curb on the lot line extended.
 - (4) No structures, fences, or landscaping allowed in utility, sanitary sewer or drainage easements.

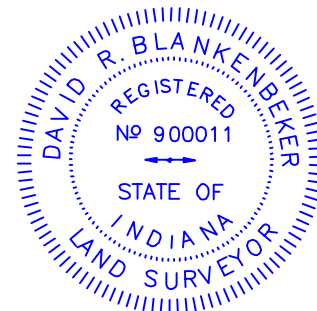

I, David R. Blankenbeker, hereby declare that there are no changes from the matter of survey since the boundary survey recorded in Computer Identification # _____ in accordance with Title 865, IAC 1.1-12 to the best of my knowledge and belief.

Registered Land Surveyor No. 900011 Date _____

BLANKENBEKER & SON
LAND SURVEYORS INC., P.C.
422 MEIGS AVENUE JEFFERSONVILLE, INDIANA
TELEPHONE (812) 282-4183 P.O. BOX 157 47131-0157
WWW.BLANKENBEKERANDSON.NET

BY: SMJ SCALE: 1" = 100 FEET DATE: AUGUST 11, 2005 JOB # 18,085-F DWG # 1620